

R100G

EAVES PROFILE

FOR TERRACES AND BALCONIES
OF THIN-LAYER RESIN



RELATED PRODUCTS:



OC 100R/90
outside 90°

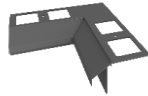

IC 100R/90
inside 90°

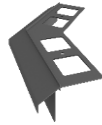

OC 100R/135
outside 135°

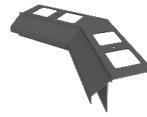

IC 100R/135
inside 135°



C 100
connector



WB 100
wall bumper

APPLICATION:

The R100G gutter profile is made of high-quality aluminum alloy covered with a polyester coating, which ensures complete resistance to corrosion and weathering. It is designed for finishing the edges of terraces and balconies with a thin layer of resin floor. The gutter strip integrated with the R100G profile allows the installation of the GR50 gutter system.

PROPERTIES:

- effective water drainage and tightness in the gutter zone
- resistance to corrosion and weather conditions
- complete solution for easy and fast installation
- optimal shape adapted to applications with thin-film resins
- possibility to install gutter system GR50

TECHNICAL DATA:

BASE	aluminum alloy with a conversion layer coated with a polyester coating
WEIGHT	500 g/m
COAT THICKNESS	min. 60 µm

COLOUR:

BASIC COLOURS:

RAL 8019

RAL 7037

RAL 7024

The color presented is illustrative. Other colors from the RAL palette are available on request.

FLOOR TYPE:

Cement or concrete screeds, other substrates with sufficient rigidity and load-bearing capacity.

BASE

PREPARATION:

The substrate must be load-bearing, level and free of contamination. Cement screeds should be crack-free, with properly formed expansion joints. Along the edge of the balcony, over the width of the mounted profile (60 mm), the substrate should have a step (reduction of about 2 mm) so that after installation of the profile, its surface is level with the substrate. The reduction can be done using an optional plastic mounting template:

1. In the case of a newly manufactured cement base - by melting / grooving the assembly template into fresh mortar.
2. In the case of a bonded cement base - by placing the assembly template, aligning the base with the upper surface with leveling mortar.

TOOLS:

Tape measure, hand or chainsaw suitable for cutting aluminum, knives, electric drills, basket mixer, stainless steel float, brush, squeegee or trowel, scale, screwdriver. It is unacceptable to use tools that cause a thermal effect (sudden rise in temperature) to cut profiles, such as angle grinders.

CONDITIONS OF IMPLEMENTATION:

Install the profiles in conditions suitable for insulating and mounting materials (soils, resins, mechanical or chemical fasteners, other materials) in accordance with the technical data sheets of these materials. Protect the sealant from excessive drying and moisture.

ASSEMBLY:

Let's start with the assembly of the corners. After their initial adjustment, mark the places of mechanical fastening, drill holes, clean the surfaces, insert the dowels of the expansion bolts. We measure straight profiles so that the expansion joints remain about 2 mm and the installation of the WB 10/100 curb on the walls. If required by the manufacturer, paint the surface to be applied with the resin. Then place a thin layer of resin on the surface of the previously performed step in the base and start the correct assembly of the profiles and ensure their even position. All profiles are pre-screwed to the base. Install the C 10/100 connectors. The expansion joint is filled with an elastic sealant along its entire length (according to the resin manufacturer's recommendations). Then apply the resin mass to the entire surface, if necessary, before inserting tapes or reinforcing fleece. To meet the requirements for non-slip surfaces, it may be required to perform sanding or decorative lining with flakes and a topcoat. All activities not related to the installation of profiles should be performed in accordance with the resin system manufacturer's instructions. The gutter system should be installed in accordance with the recommendations of the GR50 gutter technical data sheet.

R100G

EAVES PROFILE

FOR TERRACES AND BALCONIES
OF THIN-LAYER RESIN



GENERAL RECOMMENDATIONS - ASSEMBLY:

Protect the profile coating from damage during work. It is not allowed to install damaged profiles. If the profiles are dirty, clean them with water as soon as possible. Do not allow dirt (eg resins) to harden on the outer surface of the profiles. The manufacturer is not liable for damage caused by incorrect use of the product, use of unsuitable accompanying materials and use of unsuitable tools. The work should be carried out in accordance with the design, technical data sheet, applicable standards, design principles and health and safety regulations.

GENERAL RECOMMENDATIONS - USE:

The profiles should be cleaned at least twice a year. For washing it is best to use clean water and a cloth, non-abrasive surface. Do not use strongly acidic or strongly alkaline cleaning agents as well as surfactants that may react with aluminum. Organic solvents containing esters, ketones, alcohols, aromatic hydrocarbons, glycol esters, chlorinated hydrocarbons and the like are not used. After each wash, the surface must be rinsed immediately with cold water. Do not use salt or chemical defrost near profiles. It is recommended to do twice a year, technical inspections of balconies and terraces, to verify the technical elements. If defects are detected, they should be removed as soon as possible.

DIMENSION:

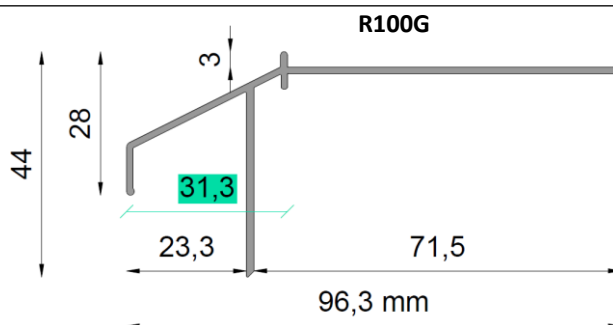

The minimum distance for which the R100G profile (without gutter) exceeds the edge of the balcony / terrace is: 31.3 mm or approximately 60 mm with the GR50 gutter installed

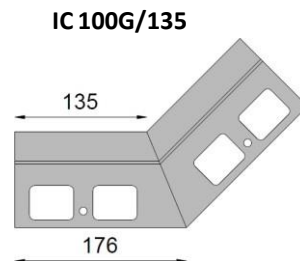
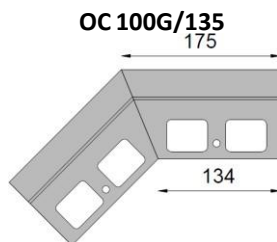
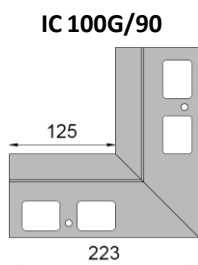
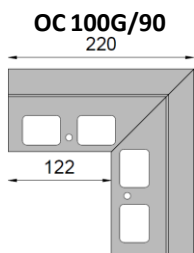

External and internal corners of any angle are available on request. Angles on site should be measured on a previously prepared foundation using a construction protractor with an accuracy of $\leq 1^\circ$.

DETAIL:

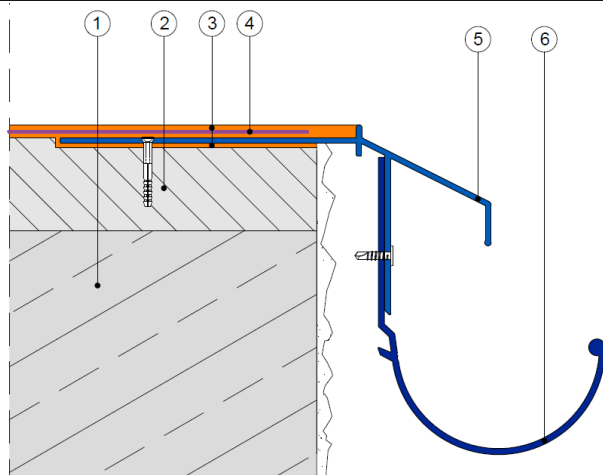

1. Support plate
2. Substrate angle 1,5-2,0%
3. System resin layer with anti-slip sprinkling
4. Reinforcing non-woven fabric
5. Profile **R100G**
6. Gutter **GR50**

RODA
renoplast

RODA Renoplast s.r.o.
Těšnovice 15
Kroměříž 767 01
tel. 00 420 737 830 493
info@rodarenoplast.cz
www.rodarenoplast.cz